

MICROZONAZIONE SISMICA

CARTA DELLE VELOCITA'  
DELLE ONDE DI TAGLIO

scala 1 : 5.000

TAV. 06

Regione Emilia-Romagna  
Comune di Medesano

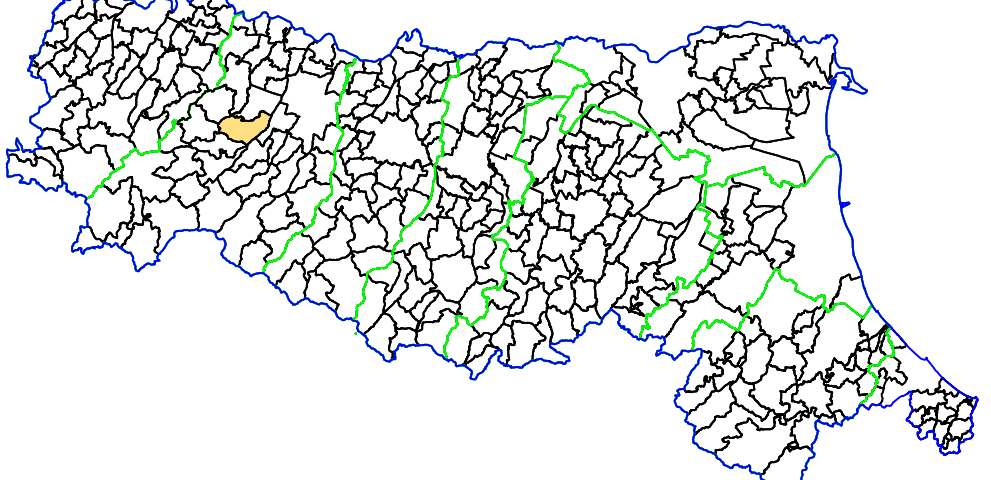

Regione

Soggetto realizzatore

Data

AMBITER S.r.l.

Via Mazzini, 5/A - 41126 Parma (PR)

Tel. 0521 942600 - Fax 0521 942610

e-mail: info@ambiter.it

PEC: ambiter@pec.ambiter.it

REGIONE EMILIA-ROMAGNA

PROTEZIONE CIVILE

SEZIONE REGIONALE

DI STUDIO

18 maggio 2018

- LEGENDA
- Indagine geofisica MASW/ReMi disponibile dall'archivio comunale

Indagine geofisica MASW/ReMi realizzata ex-novo per il presente Studio di MS

Ambito interessato dallo studio di microzonazione sismica

Confine comunale

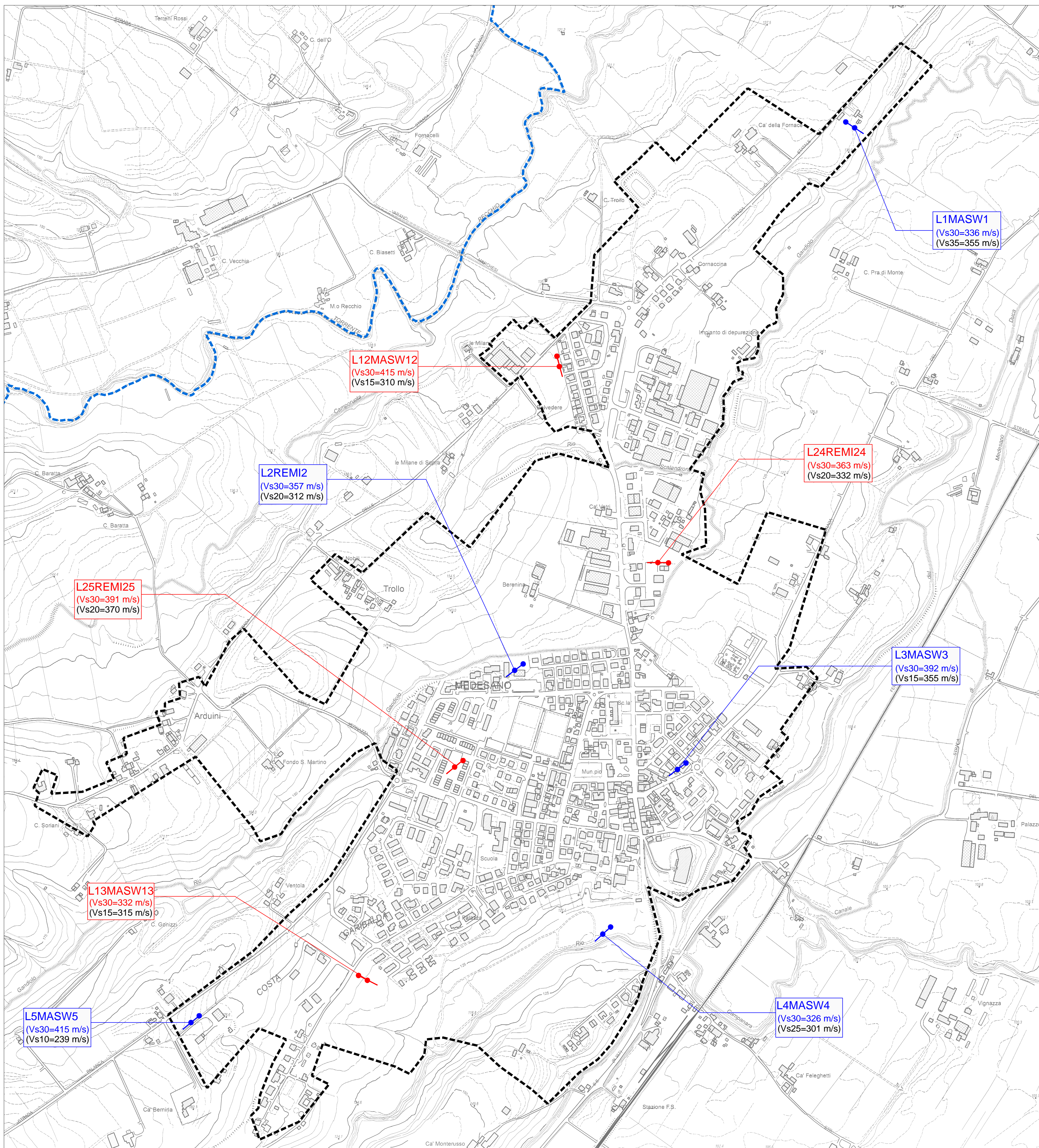

MEDESANO CAPOLUOGO (a)

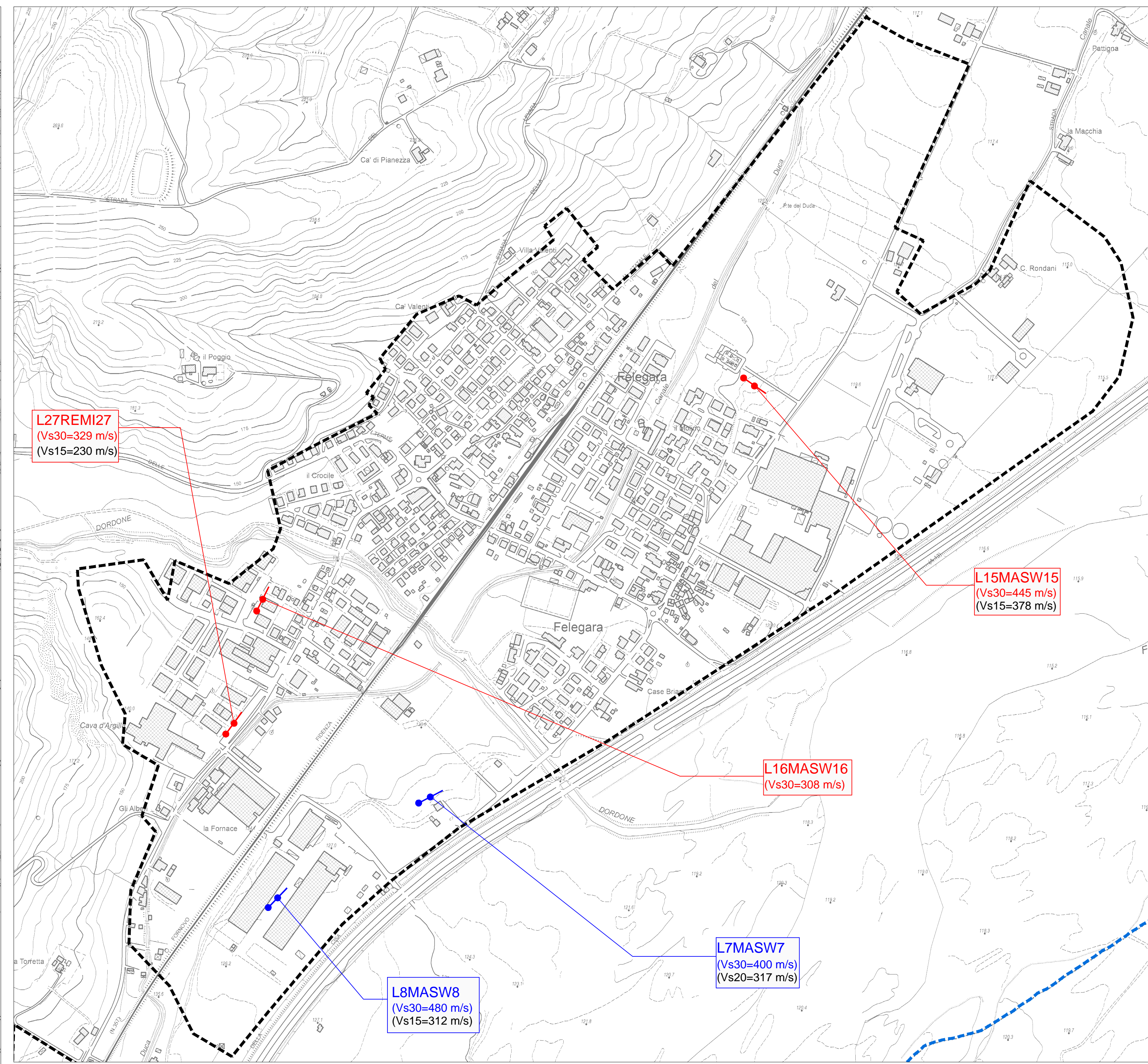

FELEGARA (b)

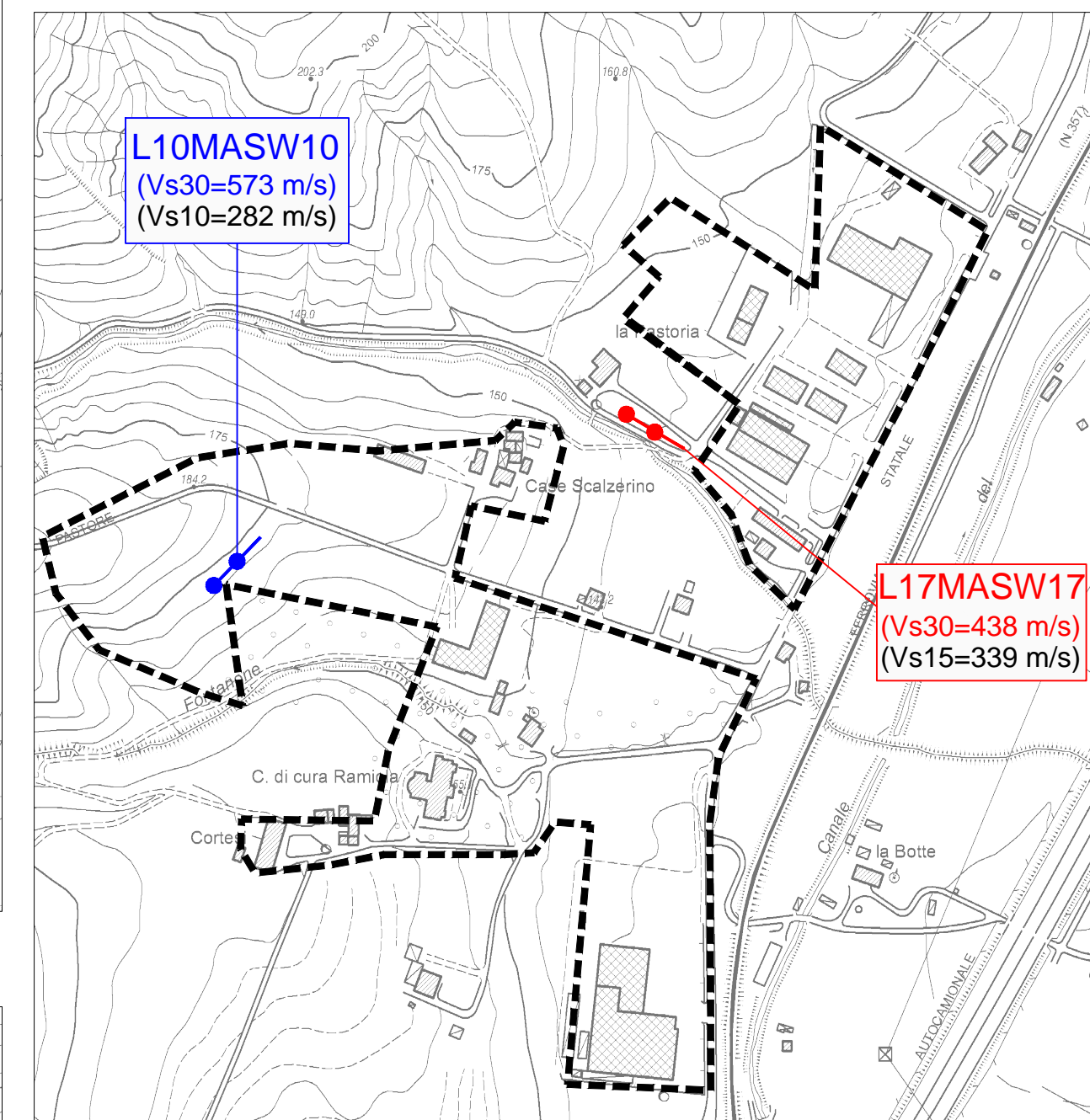

RAMIOLA (c1)

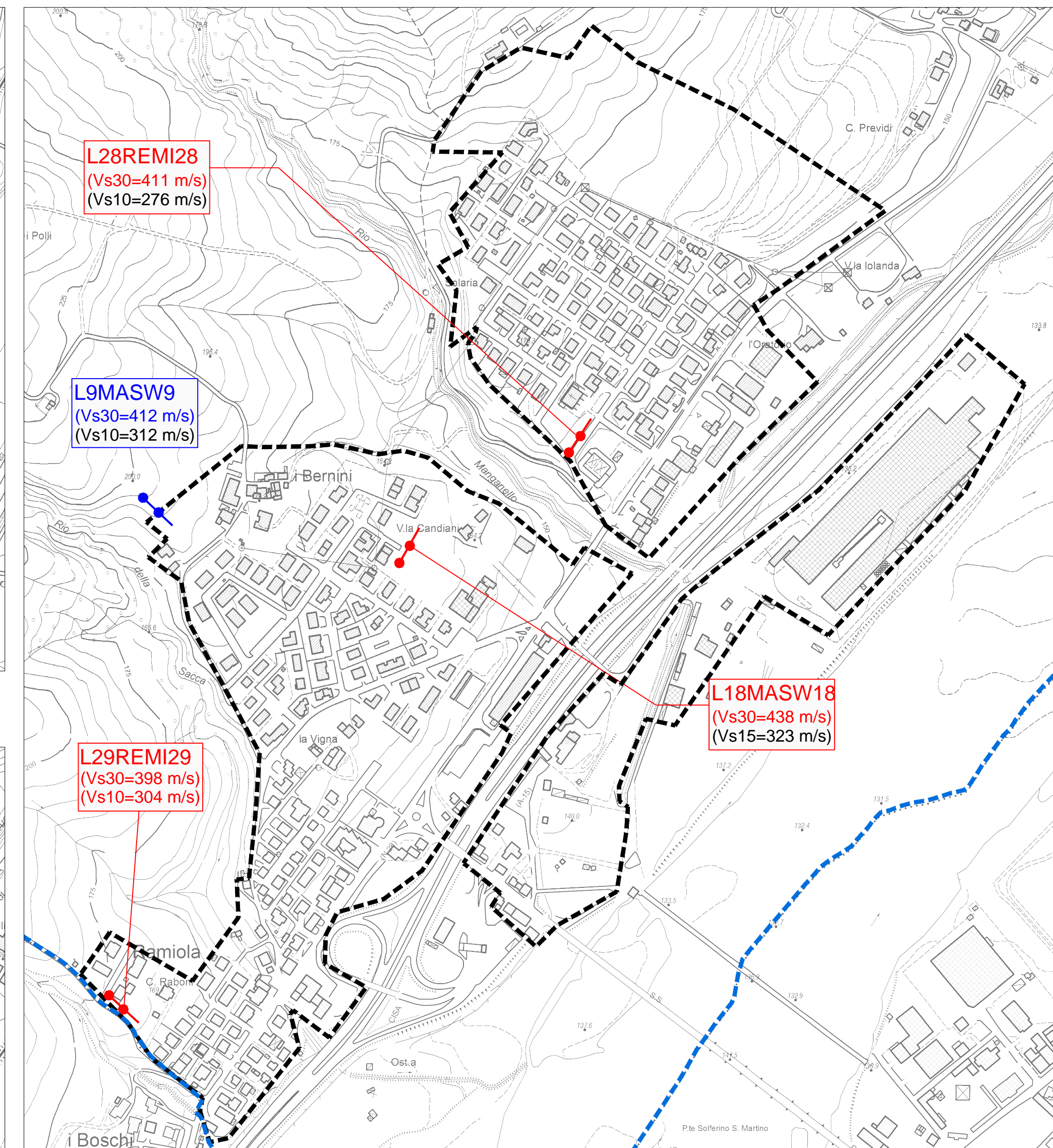

RAMIOLA (c2)

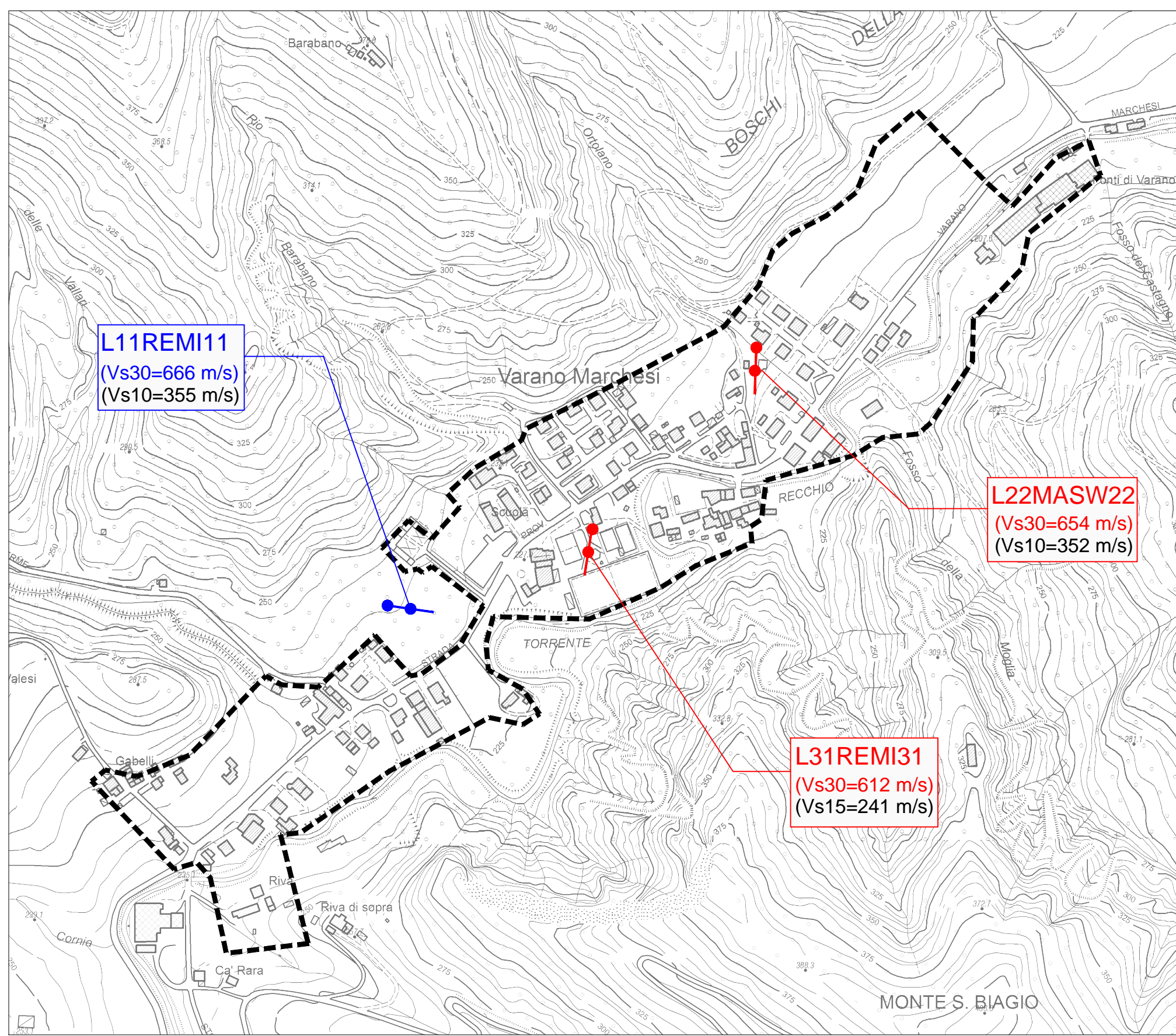

VARANO MARCHESI (f)

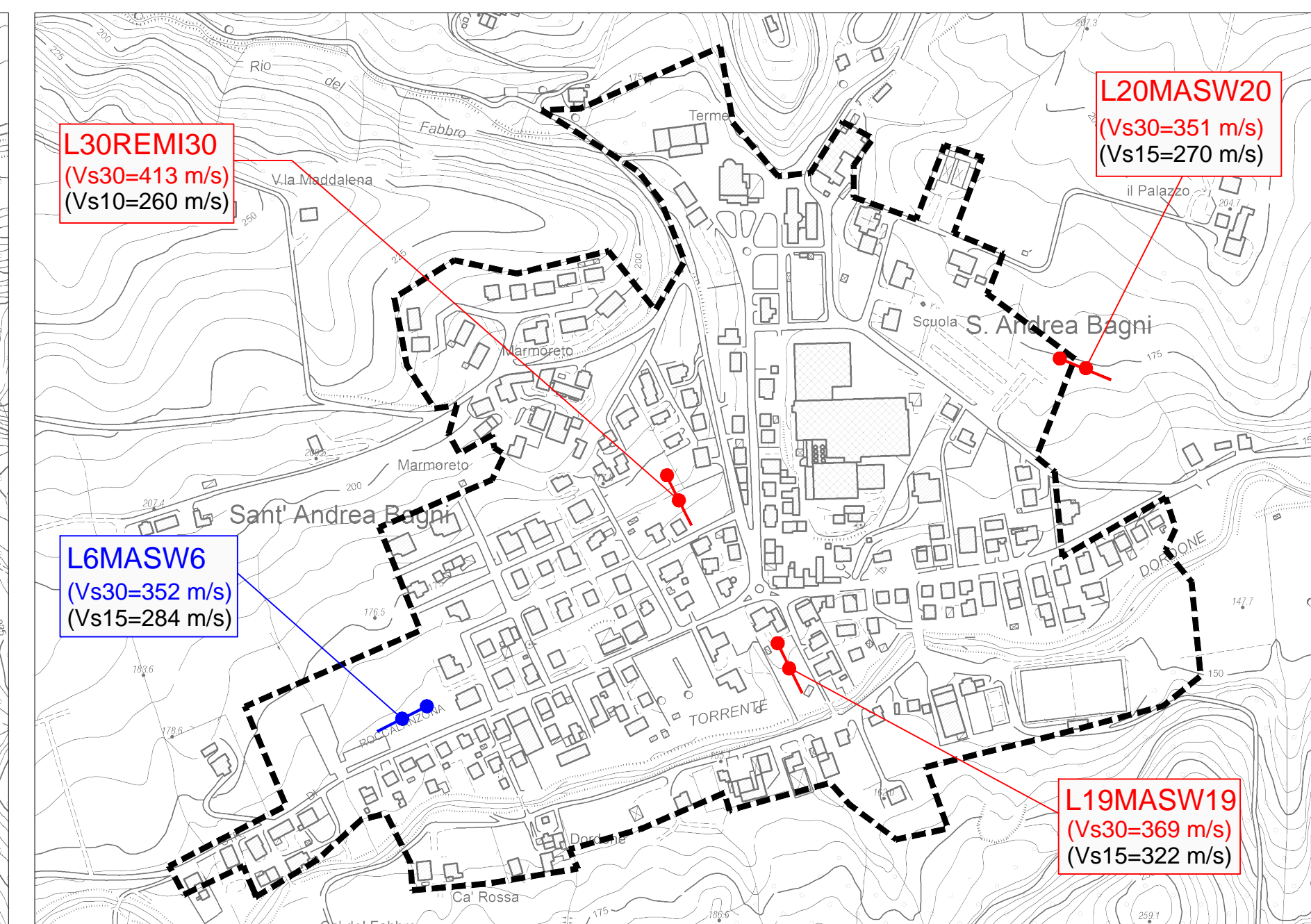

SANT'ANDREA BAGNI (e)

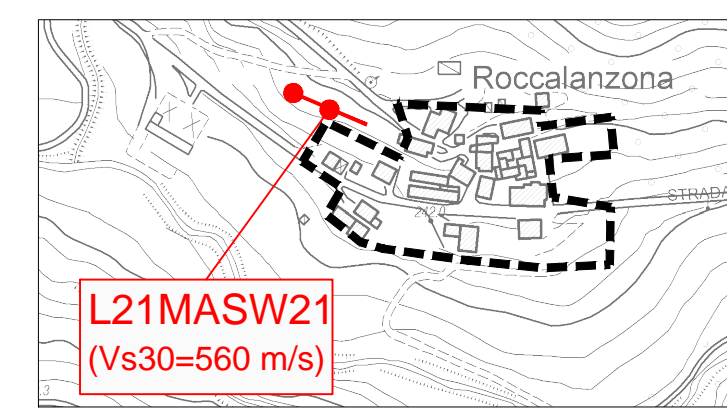

ROCCALANZONA (g)

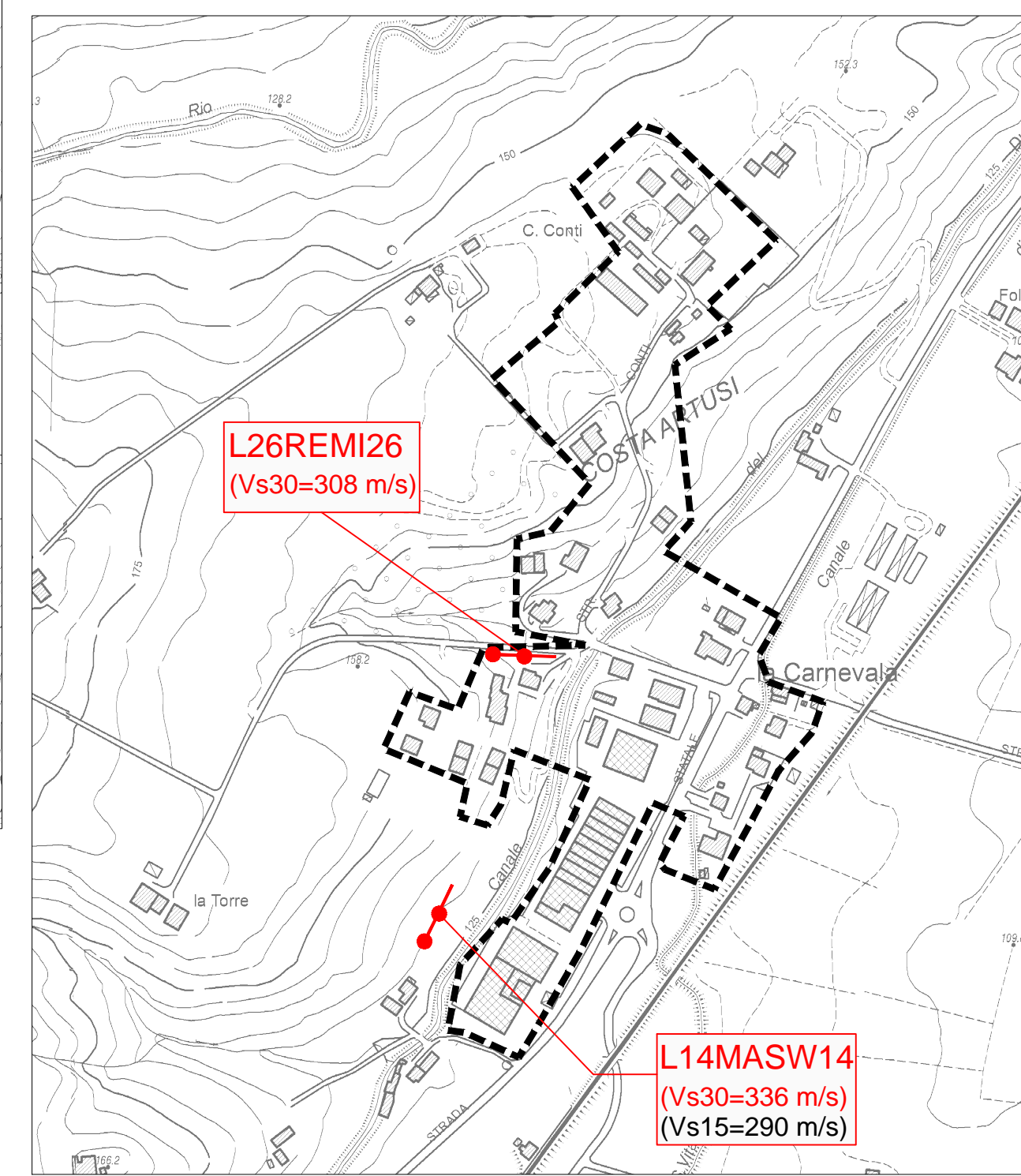

CARNEVALA (d)

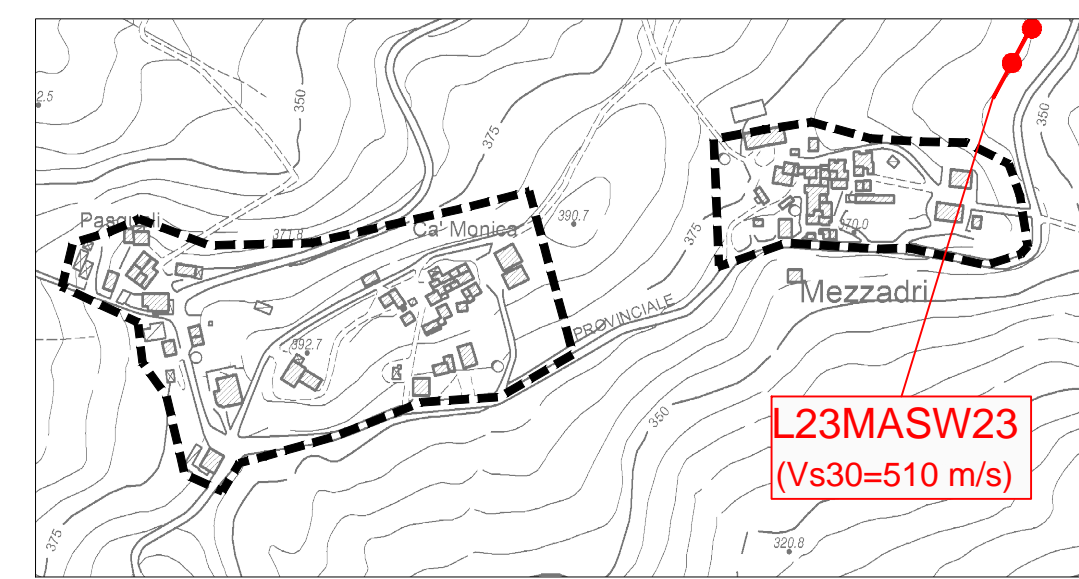

CASE MEZZADRI (h)

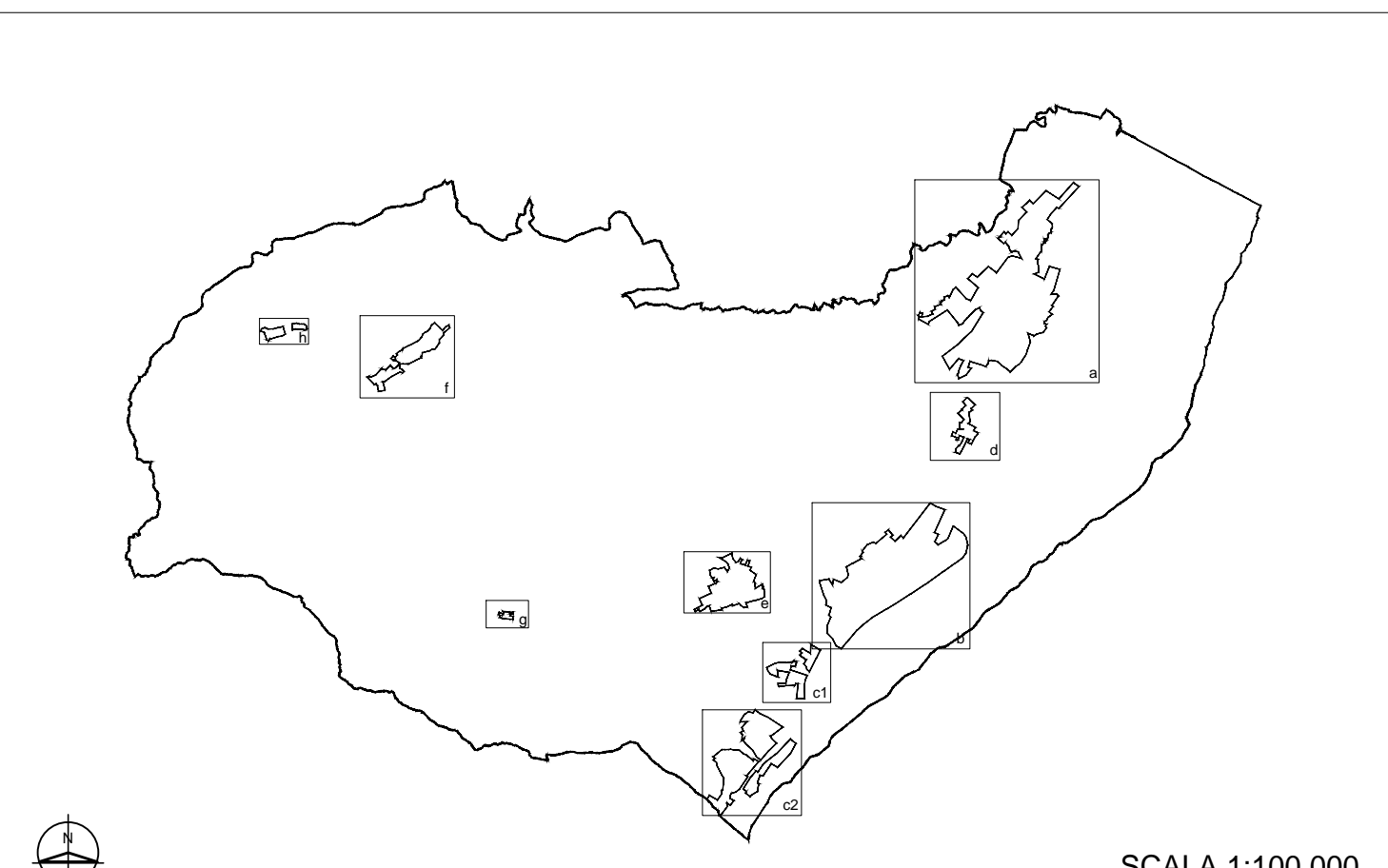

SCALA 1:100.000